



**TOSHIBA**

TOSHIBA STANDARD PASSENGER ELEVATORS

# DESIGN SELECTION

## Safety Cautions

- Observance of relevant laws / regulations are required.
- Read the entire "Instruction Manual" carefully before use, for important information about safety, handling and operation.

**TOSHIBA**

Toshiba Elevator and Building Systems Corporation

72-34, Horikawa-cho, Saiwai-ku, Kawasaki  
212-8585, Japan  
PHONE: +81-44-331-7057 FAX: +81-44-548-9597

• The data given in this catalog are subject to change without notice.

\* Revised publication effective Sept. 2019

# THE SOLUTIONS

## COMPANY SOLUTIONS

---

Toshiba Elevator and Building Systems Corporation has built a framework which encompasses all aspects from system development to production, sales to marketing, installation, adjustment, maintenance and services in order to provide clients with the highest quality products and services.

Utilizing the comprehensive technological infrastructure developed by Toshiba Group in more than 140 years since its foundation, we aim to enhance the leading edge technology and quality that we used to develop the ultra high speed elevator, harnessing Toshiba's technological innovations to their fullest extent. To meet clients' expectations and requirements for safe and pleasant elevators as well as constantly pursuing further innovation and improvement. Furthermore, we are aiming to strengthen system development, production, enhancing sales channel and sales partnership to expand in the global market.

## TOSHIBA STANDARD PASSENGER ELEVATORS DESIGN SELECTION

### Appearances Worthy of the Building

---

When a person enters a building, the first room to step inside is the elevator. The elevator plays an important role as a face deciding the first impression of the building and provides an enjoyable time in traveling from one floor to another.

It is the Toshiba elevator which elegantly and vividly produces a personality by means of a variety of expressions in line with the atmosphere of any building.

### Contents

---

#### The Solutions

Company Solutions	P.1
Appearances Worthy of the Building	P.2

#### Car Design

New Ceiling Design	P.4
Car Design	P.5

#### Hall Design

Hall Design Style of Standard Model	P.34
Hall Decoration Item Variation	P.35

#### Operation Systems

Operation Systems	P.39
-------------------	------

#### Color & Material Variations

Color Variation	P.59
-----------------	------

#### Other Optional Items

	P.61
--	------

# CAR DESIGN

## New Ceiling Design

Wide variety of newly developed LED lighting available. \*Note 1

\*Development of environmentally conscious LED lighting.

LED lighting realizes mercury-free, energy-saving and long life.

The electric consumption fall about 85% and the product life time will be increased by 20 times.

Therefore LED lighting reduces CO<sub>2</sub> emissions.

Note 1: Applied in car design SL-V1, SL-V2, SL-3, TL-1, DLX-21, DLX-22, DLX-23, DLX-24, DLX-25, PRM-1, PRM-2.

Note 2: Car design SL-1, SL-2 has four square shaped lights at the center, and round LED light at corners.



PRM-1

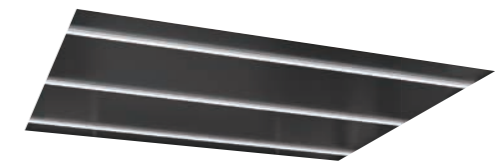

PRM-2

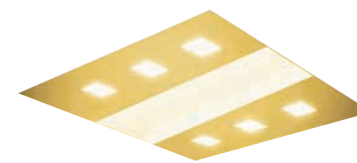

DLX-25 / DX-25



DLX-24 / DX-24



DLX-23 / DX-23



DLX-22 / DX-22



DLX-21 / DX-21

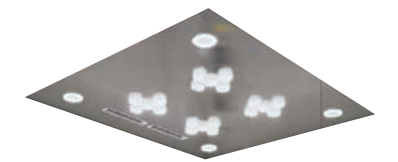

TL-1

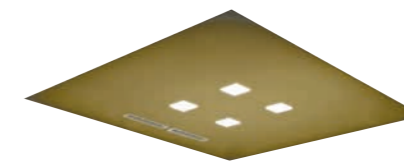

SL-V1

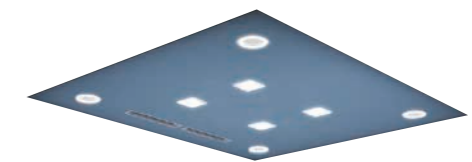

SL-1

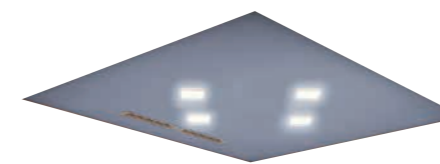

SL-V2



SL-2

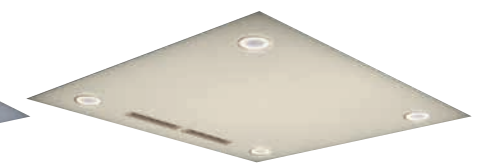

SL-3



PRM-1

Ceiling  
All-area Glass fiber cloth lighting  
(LED lights)

The actual product colors may vary slightly from those printed colors in this catalog.

# Car Design

OPTIONAL

## PRM-1

*Ceiling*  
All-area Glass fiber cloth lighting (LED lights)

Front side view



Car side panel (Return panel)	Vibration finish stainless steel (RJ-002)
Car side panel (Side panel)	Black color hairline finish stainless steel (RJ-006) and Vibration finish stainless steel (RJ-002)
Car side panel (Rear panel)	Black color hairline finish stainless steel (RJ-006) and Mirror finish stainless steel (RJ-005)
Kick plate	Hairline finish stainless steel (RJ-001)
Column	Nil
Car door	Black color hairline finish stainless steel (RJ-006)
Car floor	Marble tile (JQ-1013)
COP	POP-G1L-104C-3A
Indicator	10.4inch LCD
Handrail	Stainless steel flat type hand rail
Remark	Applies to models with a capacity over 1150kg and more than 15persons.

Back side view



The actual product colors may vary slightly from those printed colors in this catalog.

OPTIONAL

## PRM-1

*Ceiling*  
All-area Glass fiber cloth lighting (LED lights)



Car side panel (Return panel)	Satin finish stainless steel (RJ-004)
Car side panel (Side panel)	Satin finish stainless steel (RJ-004)
Car side panel (Rear panel)	Satin finish stainless steel (RJ-004)
Kick plate	Hairline finish stainless steel (RJ-001)
Column	Nil
Car door	Satin finish stainless steel (RJ-004)
Car floor	Vinyl tile (MID-833)
COP	POP-G1L-84C-1A
Indicator	8.4inch LCD
Remark	Applies to models with a capacity over 1150kg and more than 15persons.

The actual product colors may vary slightly from those printed colors in this catalog.

# Car Design

OPTIONAL

## PRM-1

*Ceiling*  
All-area Glass fiber cloth lighting (LED lights)

Front side view



Back side view

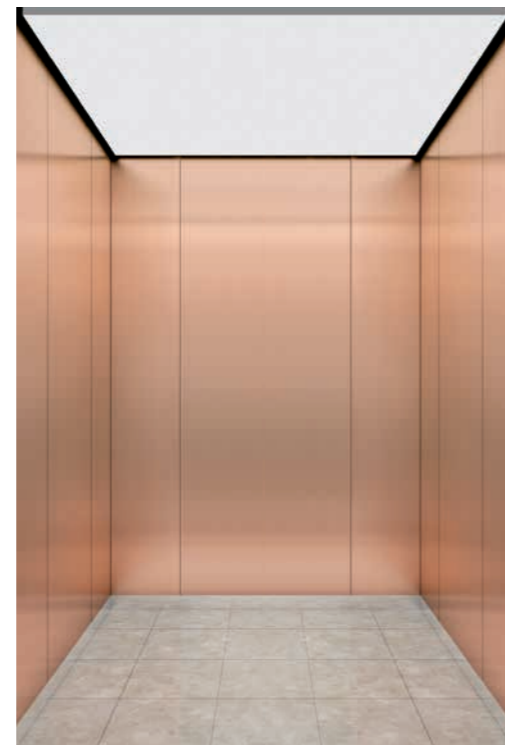

Car side panel (Return panel)	Vibration finish stainless steel (RJ-002)
Car side panel (Side panel)	Rose gold color hairline finish stainless steel (RJ-007)
Car side panel (Rear panel)	Rose gold color hairline finish stainless steel (RJ-007)
Kick plate	Hairline finish stainless steel (RJ-001)
Column	Hairline finish stainless steel (RJ-001)
Car door	Vibration finish stainless steel (RJ-002)
Car floor	Vinyl tile (MID-806)
COP	COP-G1W-7B
Indicator	Dot type LED (White color)
Remark	Applies to models with a capacity over 1150kg and more than 15persons.

The actual product colors may vary slightly from those printed colors in this catalog.

OPTIONAL

## PRM-1

*Ceiling*  
All-area Glass fiber cloth lighting (LED lights)

Front side view



Back side view



Car side panel (Return panel)	Bronze color hairline finish stainless steel (RJ-008)
Car side panel (Side panel)	Bronze color hairline finish stainless steel (RJ-008)
Car side panel (Rear panel)	Bronze color hairline finish stainless steel (RJ-008)
Kick plate	Hairline finish stainless steel (RJ-001)
Column	Hairline finish stainless steel (RJ-001)
Car door	Bronze color hairline finish stainless steel (RJ-008)
Car floor	Vinyl tile (MID-823)
COP	COP-G1W-7B
Indicator	Dot type LED (White color)
Remark	Applies to models with a capacity over 1150kg and more than 15persons.

The actual product colors may vary slightly from those printed colors in this catalog.

# Car Design

OPTIONAL

## PRM-2

Ceiling  
Acrylic block LED lighting



Car side panel (Return panel)	Black color hairline finish stainless steel (RJ-006)
Car side panel (Side panel)	Black color hairline finish stainless steel (RJ-006) and Mirror finish stainless steel (RJ-005)
Car side panel (Rear panel)	Black color hairline finish stainless steel (RJ-006)
Kick plate	Hairline finish stainless steel (RJ-001)
Column	Nil
Car door	Mirror etching finish stainless steel (RJ-005DZ007)
Car floor	Vinyl tile (TSF-1C)
COP	POP-G1L-1B
Indicator	Dot type LED light (White color)
Remark	Applies to models with a capacity over 1150kg and more than 15persons.

The actual product colors may vary slightly from those printed colors in this catalog.

OPTIONAL

## PRM-2

Ceiling  
Acrylic block LED lighting

Front side view



Car side panel (Return panel)	Vibration finish stainless steel (RJ-002)
Car side panel (Side panel)	Gold color hairline finish stainless steel (RJ-009)
Car side panel (Rear panel)	Gold color hairline finish stainless steel (RJ-009)
Kick plate	Hairline finish stainless steel (RJ-001)
Column	Hairline finish stainless steel (RJ-001)
Car door	Gold color hairline finish stainless steel (RJ-009)
Car floor	Vinyl tile (TSF-1A)
COP	COP-G1W-7B
Indicator	Dot type LED (White color)
Remark	Applies to models with a capacity over 1150kg and more than 15persons.

The actual product colors may vary slightly from those printed colors in this catalog.

Back side view



# Car Design

OPTIONAL

**PRM-2** *Ceiling*  
Acrylic block LED lighting



Car side panel (Return panel)	Black color hairline finish stainless steel (RJ-006)
Car side panel (Side panel)	Black color hairline finish stainless steel (RJ-006) and Mirror finish stainless steel (RJ-005)
Car side panel (Rear panel)	Black color hairline finish stainless steel (RJ-006)
Kick plate	Hairline finish stainless steel (RJ-001)
Column	Hairline finish stainless steel (RJ-001)
Car door	Hairline finish stainless steel (RJ-001)
Car floor	Vinyl tile (MID-834)
COP	COP-G1B-3B
Indicator	Dot type LED light (White color)
Remark	Applies to models with a capacity over 1150kg and more than 15persons.

The actual product colors may vary slightly from those printed colors in this catalog.

OPTIONAL

**DLX-25** *Ceiling*  
Gold car decoration combined with symmetrical pattern looks steady and magnificent (LED lights)

OPTIONAL

**DX-25** *Ceiling*  
Gold car decoration combined with symmetrical pattern looks steady and magnificent



Car side panel (Return panel)	Gold color hairline finish stainless steel (RJ-009)
Car side panel (Side panel)	Gold color hairline finish stainless steel (RJ-009) and Gold color mirror finish stainless steel (RJ-014)
Car side panel (Rear panel)	Gold color hairline finish stainless steel (RJ-009)
Kick plate	Hairline finish stainless steel (RJ-001)
Column	Hairline finish stainless steel (RJ-001)
Car door	Gold color mirror finish stainless steel (RJ-014)
Car floor	Vinyl tile (TSF-1B)
COP	COP-G1S-1A
Indicator	Dot type LED light (Orange color)
Handrail	Stainless steel flat type hand rail
Remark	Applies to models with a capacity over 1150kg and more than 15persons.



Car side panel (Return panel)	Gold color hairline finish stainless steel (RJ-009)
Car side panel (Side panel)	Gold color hairline finish stainless steel (RJ-009) and Gold color mirror finish stainless steel (RJ-014)
Car side panel (Rear panel)	Gold color hairline finish stainless steel (RJ-009)
Kick plate	Nil
Column	Nil
Car door	Gold color mirror finish stainless steel (RJ-014)
Car floor	Vinyl tile (TSF-1B)
COP	COP-G1S-1A
Indicator	Dot type LED light (Orange color)
Handrail	Stainless steel flat type hand rail
Remark	Applies to models with a capacity of less than 1050kg and fewer 14persons.

The actual product colors may vary slightly from those printed colors in this catalog.

# Car Design

OPTIONAL

**DLX-24** *Ceiling*  
Large-area lighting, square pattern at the center (LED lights)

Front side view



Car side panel (Return panel)	Bronze color mirror finish stainless steel (RJ-013)
Car side panel (Side panel)	Bronze color hairline finish stainless steel (RJ-008)
Car side panel (Rear panel)	Bronze color hairline finish stainless steel (RJ-008) and Bronze color mirror finish stainless steel (RJ-013)
Kick plate	Hairline finish stainless steel (RJ-001)
Column	Nil
Car door	Bronze color mirror finish stainless steel (RJ-013)
Car floor	Marble tile (JRFL002)
COP	POP-G1L-104C-5A
Sub COP	POP-G1L-104C-5A
Indicator	10.4inch LCD
Remark	Applies to models with a capacity over 1150kg and more than 15persons.

Back side view

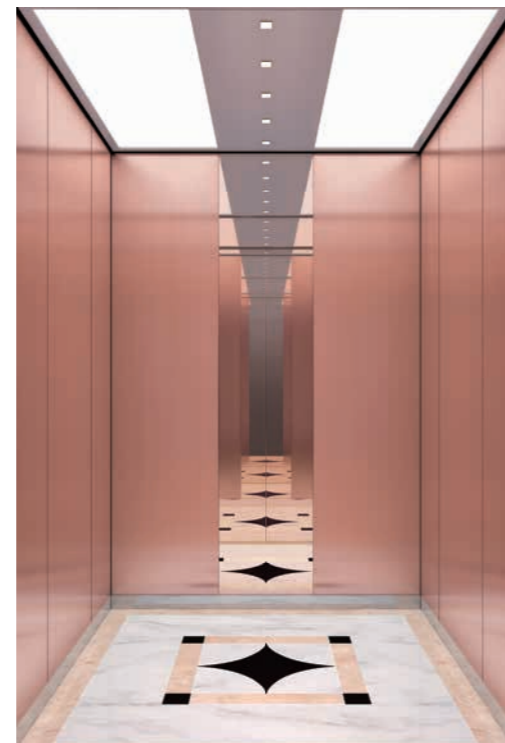

The actual product colors may vary slightly from those printed colors in this catalog.

OPTIONAL

**DLX-24** *Ceiling*  
Large-area lighting, square pattern at the center (LED lights)



Car side panel (Return panel)	Sand blast finish stainless steel (RJ-003)
Car side panel (Side panel)	Sand blast finish stainless steel (RJ-003)
Car side panel (Rear panel)	Sand blast finish stainless steel (RJ-003)
Kick plate	Hairline finish stainless steel (RJ-001)
Column	Hairline finish stainless steel (RJ-001)
Car door	Sand blast finish stainless steel (RJ-003)
Car floor	Vinyl tile (TSF-1B)
COP	COP-G1A-3A
Indicator	Dot type LED light (Orange color)
Remark	Applies to models with a capacity over 1150kg and more than 15persons.

The actual product colors may vary slightly from those printed colors in this catalog.



# Car Design

OPTIONAL

## DLX-24

Ceiling

Large-area lighting, square pattern at the center (LED lights)

Front side view



Car side panel (Return panel)	Vibration finish stainless steel (RJ-002)
Car side panel (Side panel)	Rose gold color hairline finish stainless steel (RJ-007)
Car side panel (Rear panel)	Rose gold color hairline finish stainless steel (RJ-007) and Mirror finish stainless steel (RJ-005)
Kick plate	Hairline finish stainless steel (RJ-001)
Column	Hairline finish stainless steel (RJ-001)
Car door	Mirror finish stainless steel (RJ-005)
Car floor	Vinyl tile (TSF-1C)
COP	COP-G1L-57B-7A
Indicator	5.7inch LCD
Handrail	Stainless steel round type hand rail
Remark	Applies to models with a capacity over 1150kg and more than 15persons.

Back side view

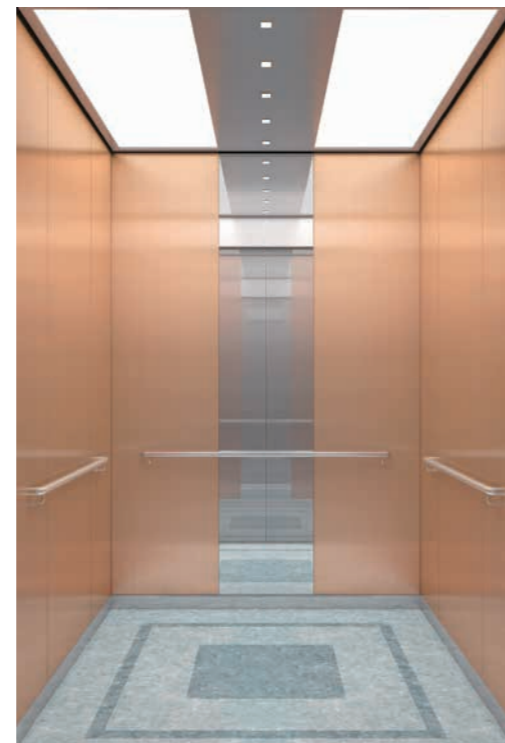

The actual product colors may vary slightly from those printed colors in this catalog.

OPTIONAL

## DLX-24

Ceiling

Large-area lighting, square pattern at the center (LED lights)



Car side panel (Return panel)	Bronze color hairline finish stainless steel (RJ-008)
Car side panel (Side panel)	Bronze color hairline finish stainless steel (RJ-008) and Mirror finish stainless steel (RJ-005)
Car side panel (Rear panel)	Bronze color hairline finish stainless steel (RJ-008)
Kick plate	Hairline finish stainless steel (RJ-001)
Column	Hairline finish stainless steel (RJ-001)
Car door	Bronze color mirror finish stainless steel (RJ-013)
Car floor	Vinyl tile (MID-809)
COP	COP-G1K-3A
Indicator	Dot type LED (Orange color)
Remark	Applies to models with a capacity over 1150kg and more than 15persons.

The actual product colors may vary slightly from those printed colors in this catalog.

# Car Design

OPTIONAL

## DLX-24

Ceiling

Large-area lighting, square pattern at the center (LED lights)



Car side panel (Return panel)	Bronze color hairline finish stainless steel (RJ-008)
Car side panel (Side panel)	Bronze color hairline finish stainless steel (RJ-008)
Car side panel (Rear panel)	Bronze color hairline finish stainless steel (RJ-008)
Kick plate	Hairline finish stainless steel (RJ-001)
Column	Hairline finish stainless steel (RJ-001)
Car door	Bronze color hairline finish stainless steel (RJ-008)
Car floor	Vinyl tile (MID-1B)
COP	COP-G1W-7B
Indicator	Dot type LED (White color)
Remark	Applies to models with a capacity over 1150kg and more than 15persons.

OPTIONAL

## DX-23

Ceiling

Large-area lighting

Front side view



Car side panel (Return panel)	Mirror finish stainless steel (RJ-005)
Car side panel (Side panel)	Sand blast finish stainless steel (RJ-003) and Mirror finish stainless steel (RJ-005)
Car side panel (Rear panel)	Sand blast finish stainless steel (RJ-003) and Mirror finish stainless steel (RJ-005)
Kick plate	Hairline finish stainless steel (RJ-001)
Column	Hairline finish stainless steel (RJ-001)
Car door	Sand blast finish stainless steel (RJ-003)
Car floor	Vinyl tile (TSF-1C)
COP	COP-G1L-57B-7A
Indicator	5.7inch LCD
Handrail	Stainless steel round type hand rail
Remark	Applies to models with a capacity over 1150kg and more than 15persons.

Back side view



The actual product colors may vary slightly from those printed colors in this catalog.

The actual product colors may vary slightly from those printed colors in this catalog.

# Car Design

OPTIONAL

**DLX-23** *Ceiling*  
Large-area lighting (LED lights)

OPTIONAL

**DX-23** *Ceiling*  
Large-area lighting



Car side panel (Return panel)	Black color hairline finish stainless steel (RJ-006)
Car side panel (Side panel)	Black color hairline finish stainless steel (RJ-006) and Mirror finish stainless steel (RJ-005)
Car side panel (Rear panel)	Black color hairline finish stainless steel (RJ-006)
Kick plate	Hairline finish stainless steel (RJ-001)
Column	Hairline finish stainless steel (RJ-001)
Car door	Black color hairline finish stainless steel (RJ-006)
Car floor	Vinyl tile (TSF-1B)
COP	COP-G1S-1A
Indicator	Dot type LED light (Orange color)
Remark	Applies to models with a capacity over 1150kg and more than 15persons.

Car side panel (Return panel)	Black color hairline finish stainless steel (RJ-006)
Car side panel (Side panel)	Black color hairline finish stainless steel (RJ-006) and Mirror finish stainless steel (RJ-005)
Car side panel (Rear panel)	Black color hairline finish stainless steel (RJ-006)
Kick plate	Nil
Column	Nil
Car door	Black color hairline finish stainless steel (RJ-006)
Car floor	Vinyl tile (TSF-1B)
COP	COP-G1S-1A
Indicator	Dot type LED light (Orange color)
Remark	Applies to models with a capacity of less than 1050kg and fewer 14persons.

The actual product colors may vary slightly from those printed colors in this catalog.

OPTIONAL

**DX-23** *Ceiling*  
Large-area lighting

Front side view



Back side view



Car side panel (Return panel)	Black color hairline finish stainless steel (RJ-006)
Car side panel (Side panel)	Black color hairline finish stainless steel (RJ-006) and Mirror finish stainless steel (RJ-005)
Car side panel (Rear panel)	Black color hairline finish stainless steel (RJ-006) and Mirror finish stainless steel (RJ-005)
Kick plate	Hairline finish stainless steel (RJ-001)
Column	Hairline finish stainless steel (RJ-001)
Car door	Black color hairline finish stainless steel (RJ-006)
Car floor	Vinyl tile (TSF-1C)
COP	COP-G1L-57B-7B
Indicator	5.7inch LCD
Remark	Applies to models with a capacity over 1150kg and more than 15persons.

The actual product colors may vary slightly from those printed colors in this catalog.

# Car Design

OPTIONAL

## DLX-22

Ceiling

Acrylic at the center, down-light propylene panel on both sides (LED lights)



Car side panel (Return panel)	Hairline finish stainless steel (RJ-001)
Car side panel (Side panel)	Hairline finish stainless steel (RJ-001)
Car side panel (Rear panel)	Hairline finish stainless steel (RJ-001)
Kick plate	Hairline finish stainless steel (RJ-001)
Column	Hairline finish stainless steel (RJ-001)
Car door	Hairline etching finish stainless steel (RJ-001DZ001)
Car floor	Vinyl tile (MID-829)
COP	COP-G1K-3A
Indicator	Dot type LED (Orange color)
Remark	Applies to models with a capacity over 1150kg and more than 15persons.

The actual product colors may vary slightly from those printed colors in this catalog.

OPTIONAL

## DLX-22

Ceiling

Acrylic at the center, down-light propylene panel on both sides (LED lights)

OPTIONAL

## DX-22

Ceiling

Acrylic at the center, down-light propylene panel on both sides



Car side panel (Return panel)	Hairline finish stainless steel (RJ-001)
Car side panel (Side panel)	Hairline finish stainless steel (RJ-001) and Mirror etching finish stainless steel (RJ-005DZ007)
Car side panel (Rear panel)	Hairline finish stainless steel (RJ-001)
Kick plate	Hairline finish stainless steel (RJ-001)
Column	Hairline finish stainless steel (RJ-001)
Car door	Mirror etching finish stainless steel (RJ-005DZ007)
Car floor	Vinyl tile (TSF-1E)
COP	COP-G1K-7A
Indicator	Dot type LED light (Orange color)
Handrail	Stainless steel round type hand rail
Remark	Applies to models with a capacity over 1150kg and more than 15persons.



Car side panel (Return panel)	Hairline finish stainless steel (RJ-001)
Car side panel (Side panel)	Hairline finish stainless steel (RJ-001) and Mirror etching finish stainless steel (RJ-005DZ007)
Car side panel (Rear panel)	Hairline finish stainless steel (RJ-001)
Kick plate	Nil
Column	Nil
Car door	Mirror etching finish stainless steel (RJ-005DZ007)
Car floor	Vinyl tile (TSF-1E)
COP	COP-G1K-7A
Indicator	Dot type LED light (Orange color)
Handrail	Stainless steel round type hand rail
Remark	Applies to models with a capacity of less than 1050kg and fewer 14persons.

The actual product colors may vary slightly from those printed colors in this catalog.

# Car Design

OPTIONAL

## DLX-21

Ceiling

Down-light with propylene panel at the center, frosted acrylic on both sides (LED lights)

OPTIONAL

## DX-21

Ceiling

Down-light with propylene panel at the center, frosted acrylic on both sides



Car side panel (Return panel)	Hairline finish stainless steel (RJ-001)
Car side panel (Side panel)	Hairline finish stainless steel (RJ-001)
Car side panel (Rear panel)	Hairline finish stainless steel (RJ-001)
Kick plate	Hairline finish stainless steel (RJ-001)
Column	Hairline finish stainless steel (RJ-001)
Car door	Mirror finish stainless steel (RJ-005)
Car floor	Vinyl tile (TSF-1E)
COP	COP-G1K-7A
Indicator	Dot type LED light (Orange color)
Handrail	Stainless steel round type hand rail
Remark	Applies to models with a capacity over 1150kg and more than 15persons.

Car side panel (Return panel)	Hairline finish stainless steel (RJ-001)
Car side panel (Side panel)	Hairline finish stainless steel (RJ-001)
Car side panel (Rear panel)	Hairline finish stainless steel (RJ-001)
Kick plate	Nil
Column	Nil
Car door	Mirror finish stainless steel (RJ-005)
Car floor	Vinyl tile (TSF-1E)
COP	COP-G1K-7A
Indicator	Dot type LED light (Orange color)
Handrail	Stainless steel round type hand rail
Remark	Applies to models with a capacity of less than 1050kg and fewer 14persons.

The actual product colors may vary slightly from those printed colors in this catalog.

OPTIONAL

## TL-1

Ceiling

Flower pattern LED lights at the center, and round LED lights at corners

Front side view



Back side view



Car side panel (Return panel)	Hairline finish stainless steel (RJ-001)
Car side panel (Side panel)	Sand blast finish stainless steel (RJ-003)
Car side panel (Rear panel)	Sand blast finish stainless steel (RJ-003) and Mirror finish stainless steel (RJ-005)
Kick plate	Hairline finish stainless steel (RJ-001)
Column	Hairline finish stainless steel (RJ-001)
Car door	Sand blast finish stainless steel (RJ-003)
Car floor	Vinyl tile (MID-833)
COP	COP-G1L-57B-7A
Indicator	5.7inch LCD
Handrail	Stainless steel round type hand rail
Remark	Applies to models with a capacity over 1150kg and more than 15persons.

The actual product colors may vary slightly from those printed colors in this catalog.

# Car Design

STANDARD

## TL-1

Ceiling

Flower pattern LED lights at the center, and round LED lights at corners



Car side panel (Return panel)	Hairline finish stainless steel (RJ-001)
Car side panel (Side panel)	Hairline finish stainless steel (RJ-001)
Car side panel (Rear panel)	Hairline finish stainless steel (RJ-001)
Kick plate	Hairline finish stainless steel (RJ-001)
Column	Hairline finish stainless steel (RJ-001)
Car door	Hairline finish stainless steel (RJ-001)
Car floor	Vinyl tile (MID-809)
COP	COP-G1S-3A
Indicator	Dot type LED (Orange color)
Remark	Applies to models with a capacity over 1150kg and more than 15persons.

OPTIONAL

## SL-1

Ceiling

Four square shaped lights at the center, and round LED lights at corners



Car side panel (Return panel)	Painted steel panel (114PB)
Car side panel (Side panel)	Painted steel panel (114PB)
Car side panel (Rear panel)	Painted steel panel (114PB)
Kick plate	Hairline finish stainless steel (RJ-001)
Column	Hairline finish stainless steel (RJ-001)
Car door	Painted steel panel (114PB)
Car floor	Vinyl tile (MID-833)
COP	COP-G1S-1A
Indicator	Dot type LED light (Orange color)
Handrail	Stainless steel round type hand rail
Remark	Applies to models with a capacity over 1150kg and more than 15persons.



Car side panel (Return panel)	Painted steel panel (114PB)
Car side panel (Side panel)	Painted steel panel (114PB)
Car side panel (Rear panel)	Painted steel panel (114PB)
Kick plate	Nil
Column	Nil
Car door	Painted steel panel (114PB)
Car floor	Vinyl tile (MID-833)
COP	COP-G1S-1A
Indicator	Dot type LED light (Orange color)
Handrail	Stainless steel round type hand rail
Remark	Applies to models with a capacity of less than 1050kg and fewer 14persons.

The actual product colors may vary slightly from those printed colors in this catalog.

The actual product colors may vary slightly from those printed colors in this catalog.

# Car Design

STANDARD

## SL-1

Ceiling

Four square shaped lights at the center, and round LED lights at corners

Type-1



Car side panel (Return panel)	Sand blast finish stainless steel (RJ-003)
Car side panel (Side panel)	Sand blast finish stainless steel (RJ-003) and Mirror finish stainless steel (RJ-005)
Car side panel (Rear panel)	Sand blast finish stainless steel (RJ-003)
Kick plate	Hairline finish stainless steel (RJ-001)
Column	Hairline finish stainless steel (RJ-001)
Car door	Mirror finish stainless steel (RJ-005)
Car floor	Vinyl tile (MID-806)
COP	COP-G1L-57B-7A
Indicator	5.7inch LCD
Remark	Applies to models with a capacity over 1150kg and more than 15persons.

Type-2



Car side panel (Return panel)	Hairline finish stainless steel (RJ-001)
Car side panel (Side panel)	Hairline finish stainless steel (RJ-001)
Car side panel (Rear panel)	Hairline finish stainless steel (RJ-001)
Kick plate	Hairline finish stainless steel (RJ-001)
Column	Hairline finish stainless steel (RJ-001)
Car door	Hairline finish stainless steel (RJ-001)
Car floor	Vinyl tile (MID-806)
COP	COP-G1L-57B-7A
Indicator	5.7inch LCD
Remark	Applies to models with a capacity over 1150kg and more than 15persons.

The actual product colors may vary slightly from those printed colors in this catalog.

STANDARD

## SL-V1

Ceiling

Four LED lights at the center



Car side panel (Return panel)	Painted steel panel (37YR)
Car side panel (Side panel)	Painted steel panel (37YR)
Car side panel (Rear panel)	Painted steel panel (37YR)
Kick plate	Hairline finish stainless steel (RJ-001)
Column	Hairline finish stainless steel (RJ-001)
Car door	Painted steel panel (37YR)
Car floor	Vinyl tile (MID-823)
COP	COP-G1S-1A
Indicator	Dot type LED light (Orange color)
Remark	Applies to models with a capacity over 1150kg and more than 15persons.



Car side panel (Return panel)	Painted steel panel (37YR)
Car side panel (Side panel)	Painted steel panel (37YR)
Car side panel (Rear panel)	Painted steel panel (37YR)
Kick plate	Nil
Column	Nil
Car door	Painted steel panel (37YR)
Car floor	Vinyl tile (MID-823)
COP	COP-G1S-1A
Indicator	Dot type LED light (Orange color)
Remark	Applies to models with a capacity of less than 1050kg and fewer 14persons.

The actual product colors may vary slightly from those printed colors in this catalog.

# Car Design

OPTIONAL

## SL-2

Ceiling

Four square shaped lights at the center, and round LED lights at corners



Car side panel (Return panel)	Hairline finish stainless steel (RJ-001)
Car side panel (Side panel)	Hairline finish stainless steel (RJ-001) and Mirror finish stainless steel (RJ-005)
Car side panel (Rear panel)	Hairline finish stainless steel (RJ-001)
Kick plate	Hairline finish stainless steel (RJ-001)
Column	Hairline finish stainless steel (RJ-001)
Car door	Hairline finish stainless steel (RJ-001)
Car floor	Vinyl tile (MID-833)
COP	COP-G1S-1A
Indicator	Dot type LED light (Orange color)
Remark	Applies to models with a capacity over 1150kg and more than 15persons.

Car side panel (Return panel)	Hairline finish stainless steel (RJ-001)
Car side panel (Side panel)	Hairline finish stainless steel (RJ-001) and Mirror finish stainless steel (RJ-005)
Car side panel (Rear panel)	Hairline finish stainless steel (RJ-001)
Kick plate	Nil
Column	Nil
Car door	Hairline finish stainless steel (RJ-001)
Car floor	Vinyl tile (MID-833)
COP	COP-G1S-1A
Indicator	Dot type LED light (Orange color)
Remark	Applies to models with a capacity of less than 1050kg and fewer 14persons.

The actual product colors may vary slightly from those printed colors in this catalog.

OPTIONAL

## SL-V2

Ceiling

Four LED lights at the center



Car side panel (Return panel)	Painted steel panel (52YR)
Car side panel (Side panel)	Painted steel panel (52YR+62Y)
Car side panel (Rear panel)	Painted steel panel (52YR+62Y)
Kick plate	Hairline finish stainless steel (RJ-001)
Column	Hairline finish stainless steel (RJ-001)
Car door	Painted steel panel (62Y)
Car floor	Vinyl tile (MID-823)
COP	COP-G1S-1A
Indicator	Dot type LED light (Orange color)
Handrail	Stainless steel round type hand rail
Remark	Applies to models with a capacity over 1150kg and more than 15persons.

Car side panel (Return panel)	Painted steel panel (52YR)
Car side panel (Side panel)	Painted steel panel (52YR+62Y)
Car side panel (Rear panel)	Painted steel panel (52YR+62Y)
Kick plate	Nil
Column	Nil
Car door	Painted steel panel (62Y)
Car floor	Vinyl tile (MID-823)
COP	COP-G1S-1A
Indicator	Dot type LED light (Orange color)
Handrail	Stainless steel round type hand rail
Remark	Applies to models with a capacity of less than 1050kg and fewer 14persons.

The actual product colors may vary slightly from those printed colors in this catalog.



# Car Design

OPTIONAL

## SL-3

*Ceiling*  
Four round LED lights at corners



Car side panel (Return panel)	Painted steel panel (1N)
Car side panel (Side panel)	Painted steel panel (1N)
Car side panel (Rear panel)	Painted steel panel (1N)
Kick plate	Hairline finish stainless steel (RJ-001)
Column	Hairline finish stainless steel (RJ-001)
Car door	Painted steel panel (1N)
Car floor	Vinyl tile (MID-823)
COP	COP-G1S-1A
Indicator	Dot type LED light (Orange color)
Remark	Applies to models with a capacity over 1150kg and more than 15persons.

Car side panel (Return panel)	Painted steel panel (1N)
Car side panel (Side panel)	Painted steel panel (1N)
Car side panel (Rear panel)	Painted steel panel (1N)
Kick plate	Nil
Column	Nil
Car door	Painted steel panel (1N)
Car floor	Vinyl tile (MID-823)
COP	COP-G1S-1A
Indicator	Dot type LED light (Orange color)
Remark	Applies to models with a capacity of less than 1050kg and fewer 14persons.

The actual product colors may vary slightly from those printed colors in this catalog.

## LED Lighting

Under equal brightness, LED lighting system only consumes 10% of electrical with comparison of an incandescent lamp and 50% of an fluorescent lamp. (part of ceiling)

Car design : PRM-1 **OPTIONAL**



\* Applies to models with a capacity of less than 1050kg and fewer 14 persons.

The actual product colors may vary slightly from those printed colors in this catalog.

# HALL DESIGN



## Hall Design Style of Standard Model



Wide type jamb

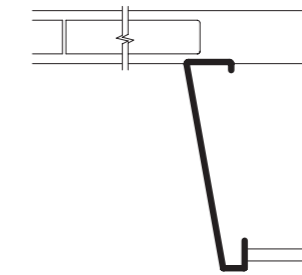

Wide type jamb with Transom

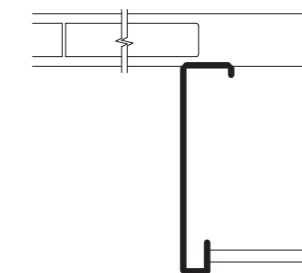

Narrow type jamb

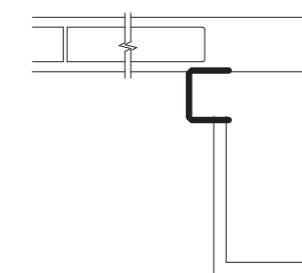

\* Note : Provided hall design specifications with the wide type jamb and transoms, when there is a need to adapt to fireproof specifications.

The actual product colors may vary slightly from those printed colors in this catalog.

# Hall Decoration Item Variation



## Hall design 1 OPTIONAL

<b>Hall jamb</b>	Wide type jamb Hairline finish stainless steel (RJ-001)
<b>Hall door</b>	Hairline finish stainless steel (RJ-001)
<b>Hall transam</b>	Hairline finish stainless steel (RJ-001)
<b>Hall sill</b>	Hardened aluminium
<b>Hall indicator</b>	Nil
<b>Hall button</b>	HB-G1S-3A
<b>Hall lantern</b>	HL-G1-O



## Hall design 4 OPTIONAL

<b>Hall jamb</b>	Wide type jamb Hairline finish stainless steel (RJ-001)
<b>Hall door</b>	Painted steel panel (37YR)
<b>Hall transam</b>	Nil
<b>Hall sill</b>	Hardened aluminium
<b>Hall indicator / Hall button</b>	HIB-G1L-43B-7A
<b>Hall lantern</b>	Nil

## Hall design 2 OPTIONAL

<b>Hall jamb</b>	Wide type jamb Painted steel panel (1N)
<b>Hall door</b>	Painted steel panel (1N)
<b>Hall transam</b>	Nil
<b>Hall sill</b>	Hardened aluminium
<b>Hall indicator</b>	HI-G34-O
<b>Hall button</b>	HB-G1K-7A
<b>Hall lantern</b>	Nil



## Hall design 5 OPTIONAL

<b>Hall jamb</b>	Wide type jamb Hairline finish stainless steel (RJ-001)
<b>Hall door</b>	Painted steel panel (114PB)
<b>Hall transam</b>	Nil
<b>Hall sill</b>	Hardened aluminium
<b>Hall indicator</b>	HI-G1-O
<b>Hall button</b>	HB-G1S-1A
<b>Hall lantern</b>	Nil



## Hall design 3 OPTIONAL

<b>Hall jamb</b>	Wide type jamb Hairline finish stainless steel (RJ-001)
<b>Hall door</b>	Hairline finish stainless steel (RJ-001)
<b>Hall transam</b>	Nil
<b>Hall sill</b>	Hardened aluminium
<b>Hall indicator</b>	Nil
<b>Hall button</b>	HB-G1S-3A
<b>Hall lantern</b>	HL-G1-O



## Hall design 6 STANDARD

<b>Hall jamb</b>	Narrow type jamb Painted steel panel (52YR)
<b>Hall door</b>	Painted steel panel (52YR)
<b>Hall transam</b>	Nil
<b>Hall sill</b>	Hardened aluminium
<b>Hall indicator / Hall button</b>	HIB-G1S-1A
<b>Hall lantern</b>	Nil

\*Note : Provided hall design specifications with the wide type jamb and transoms, when there is a need to adapt to fireproof specifications.

The actual product colors may vary slightly from those printed colors in this catalog.

\*Note : Provided hall design specifications with the wide type jamb and transoms, when there is a need to adapt to fireproof specifications.

The actual product colors may vary slightly from those printed colors in this catalog.

# OPERATION SYSTEMS



# Operation Systems

## POP type G1L series

Car Operating Panel **OPTIONAL**



POP-G1L-104C-3A



10.4 inch LCD



KB-3 (Orange light)

PRM-1 **OPTIONAL**



Car Operating Panel **OPTIONAL**

<Sub Panel>



POP-G1L-104C-5A

<Main Panel>



POP-G1L-104C-5A



10.4 inch LCD



KB-5 (Orange light)

DLX-24 **OPTIONAL**

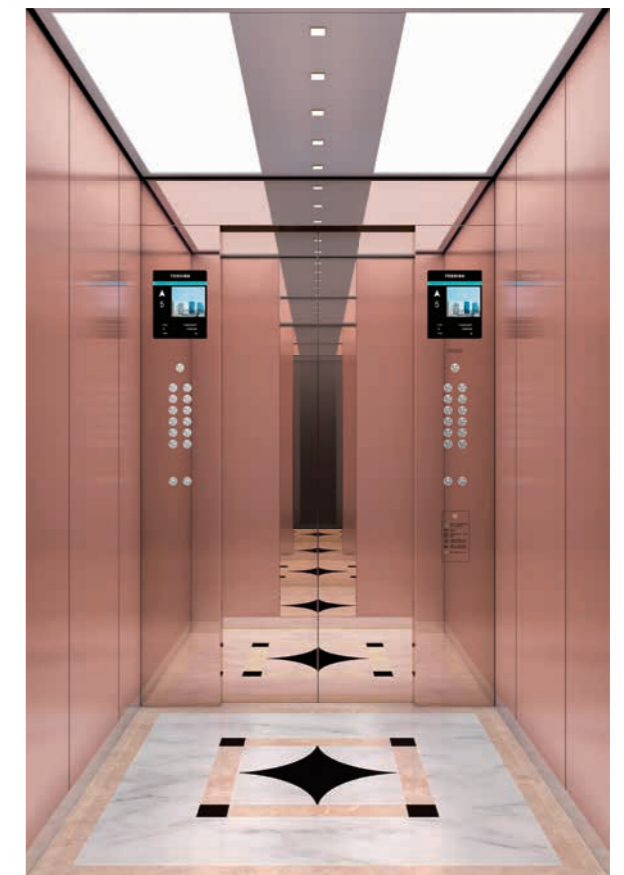

The actual product colors may vary slightly from those printed colors in this catalog.

The actual product colors may vary slightly from those printed colors in this catalog.

# Operation Systems

## POP type G1L series

Car Operating Panel **OPTIONAL**

<Return Panel Series>



POP-G1L-84C-1A



8.4 inch LCD



KB-1 (Orange light)

PRM-1 **OPTIONAL**



Car Operating Panel **OPTIONAL**

<Return Panel Series>



POP-G1L-1B



White light



KB-1 (White light)

DX-23 **OPTIONAL**



The actual product colors may vary slightly from those printed colors in this catalog.

The actual product colors may vary slightly from those printed colors in this catalog.

# Operation Systems

## FCOP type G1L series

Car Operating Panel **OPTIONAL**

<Full Height Series>



FCOP-G1L-84C-5A  
(8.4 inch LCD)



8.4 inch LCD



KB-5 (Orange light)

DLX-24 **OPTIONAL**



## COP type G1L series

Car Operating Panel **OPTIONAL**



COP-G1L-57B-5A  
(5.7 inch LCD) 3mm



5.7 inch LCD



KB-5 (Orange light)

SL-1



The actual product colors may vary slightly from those printed colors in this catalog.

The actual product colors may vary slightly from those printed colors in this catalog.

# Operation Systems

## COP type G1A series

Car Operating Panel **OPTIONAL**

<Full Height Series>



COP-G1A-3A



Orange light



KB-3  
(Orange light)

DLX-24 **OPTIONAL**

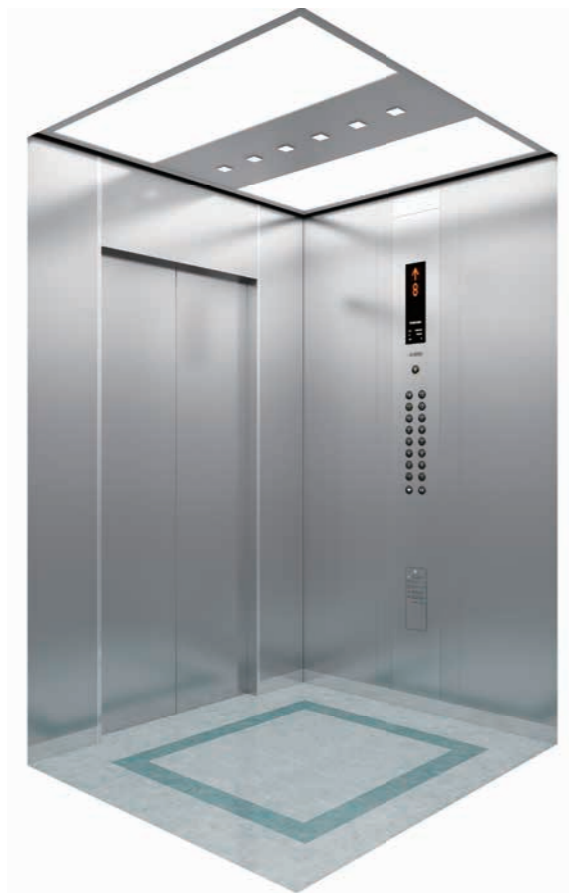

<Full Height Series>



COP-G1B-3B



White light



KB-3  
(White light)

PRM-2 **OPTIONAL**





# Operation Systems

## COP type G1W series

Car Operating Panel **OPTIONAL**

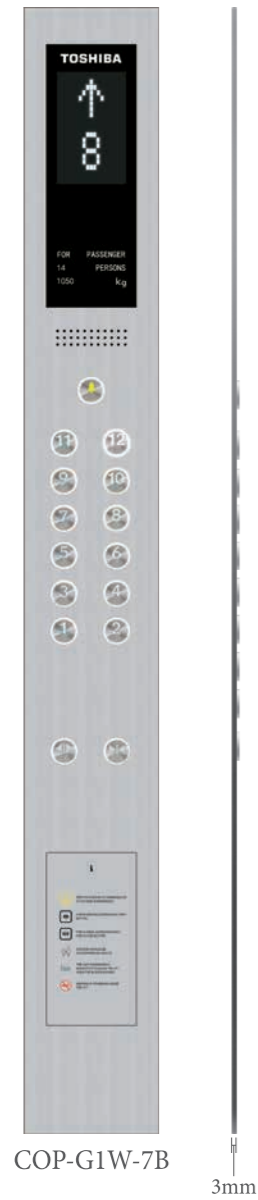

White light



KB-7  
(White light)

DLX-24 **OPTIONAL**



The actual product colors may vary slightly from those printed colors in this catalog.

## COP type G1K series

Car Operating Panel **OPTIONAL**



Orange light



KB-7  
(Orange light)

DLX-21 **OPTIONAL**



The actual product colors may vary slightly from those printed colors in this catalog.

# Operation Systems

## COP type G1U series

Car Operating Panel **OPTIONAL**

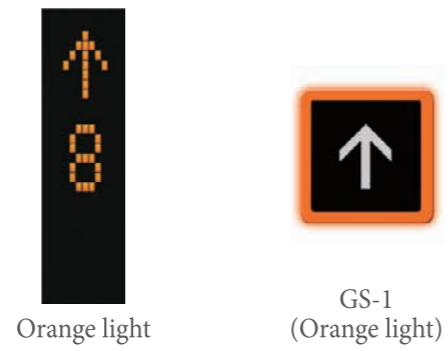

TL-1 **OPTIONAL**



The actual product colors may vary slightly from those printed colors in this catalog.

## COP type G1S series

Car Operating Panel **STANDARD**

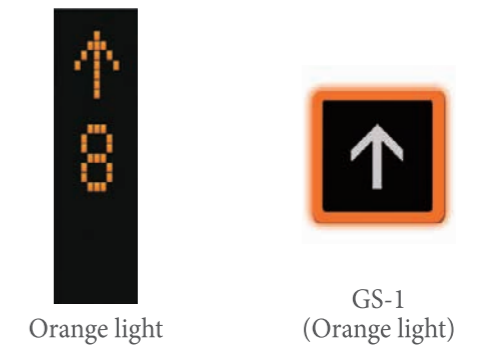

SL-V1 **STANDARD**



The actual product colors may vary slightly from those printed colors in this catalog.

# Operation Systems

## Full color LCD indicator

### Large LCD indicator for car operation panel OPTIONAL

These 10.4 inch and 8.4 inch LCD indicators are capable of displaying in the elevator's various conditions (emergency operations, maintenance status) in large icons and letter in highly visible colors.

#### 10.4 inch display for car operation panel

General car display (Without monitoring)

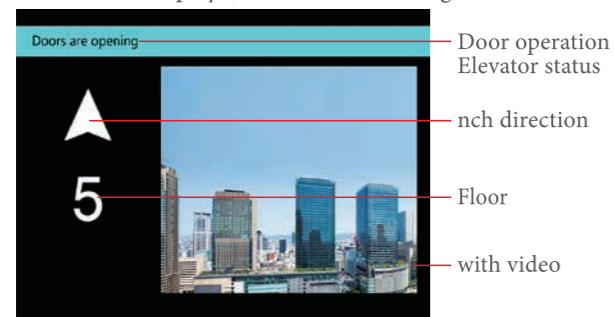

#### 8.4 inch display for car operation panel

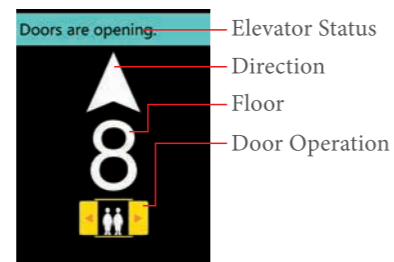

General car display (With monitoring)

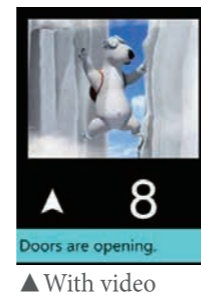
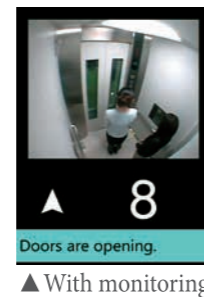
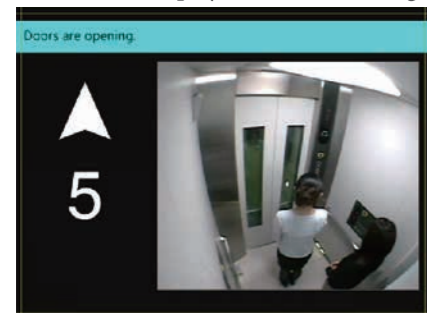

Display under controlled status

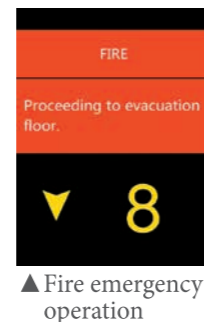
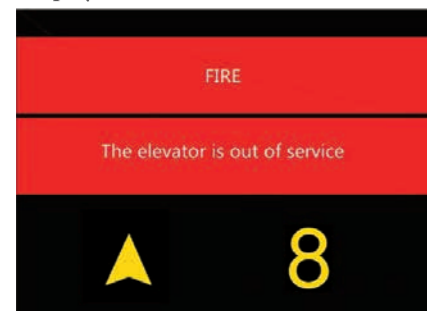

### 5.7 inch display for car operation panel

General car display



With monitoring

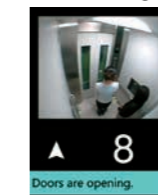

With video

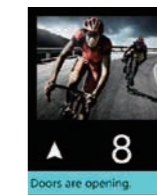

Controlled status

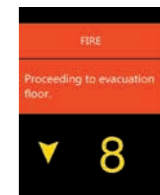

### LCD hall indicator and button OPTIONAL

Toshiba's universal designed 4.3 inch LCD hall indicators are capable of displaying various announcements such as emergency operation, maintenance status, etc.



General hall display

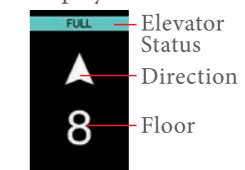

Controlled status

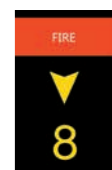

### LCD hall indicator OPTIONAL

5.7 inch large LCD hall indicator is capable of displaying visuals linked from car security camera.

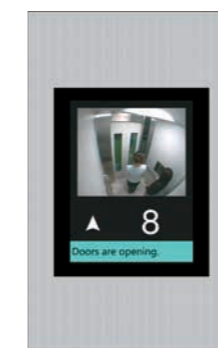

General hall display

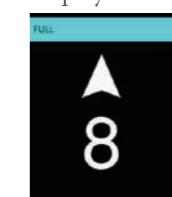

Hall controled display



# Operation Systems

## G1L / G1W series

### Hall Indicator Button Panel



#### Installation for Hall Indicator Button

\*G1S, G1U Series

- Thick type design and compact size
- Φ60 threading holes prevent damage to the building

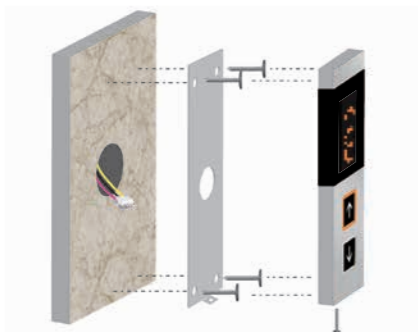

\*G1K Series : Thin type design for faceplate with a box on the back of the plate. The sleeve of the wall is necessary for mounting.

#### Simple Installation Structure

\*G1S, G1U Series

- Hidden screw fixing, better aesthetic, secure, steal-proof



## G1S / G1K / G1U series

### Hall Indicator Button Panel



The actual product colors may vary slightly from those printed colors in this catalog.

The actual product colors may vary slightly from those printed colors in this catalog.

# Operation Systems

## Digital LED dot type

### Car and hall indicator display



The actual product colors may vary slightly from those printed colors in this catalog.

## Hall Lantern and Hall Indicator

### Hall Lantern OPTIONAL

\*Note: A white light or orange light can also be selected for the lantern light.

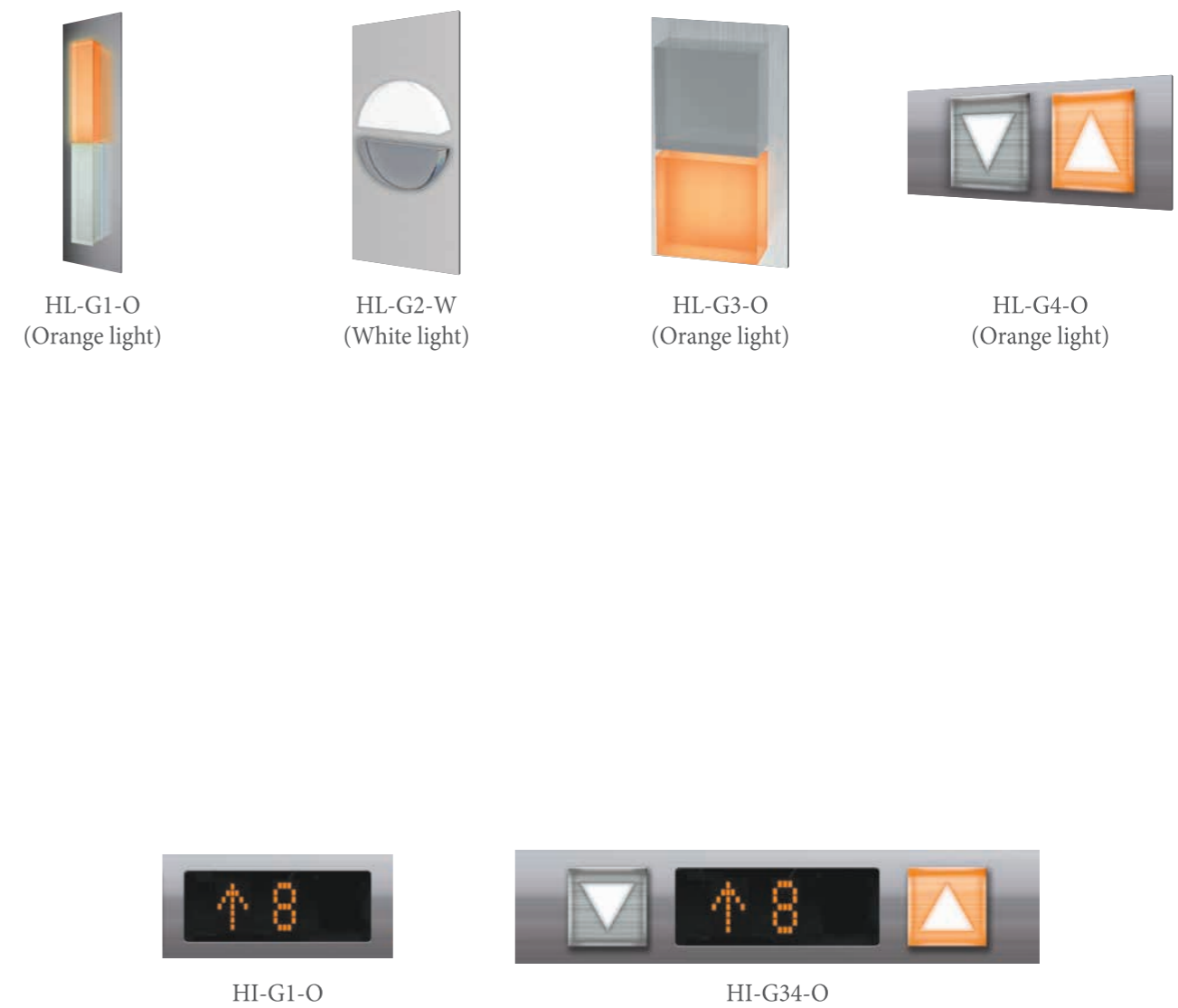

The actual product colors may vary slightly from those printed colors in this catalog.

# Operation Systems

## Button Variation

For use with series G1S / G1U only.



For use with series G1A / G1B / G1L / G1W / G1K only. **OPTIONAL**



As for UB-1 and UB-2 type, only amber light buttons are available.

The actual product colors may vary slightly from those printed colors in this catalog.

The actual product colors may vary slightly from those printed colors in this catalog.

# Color & Material Variations

## Color Variation

Paint colors for steel panels **STANDARD**

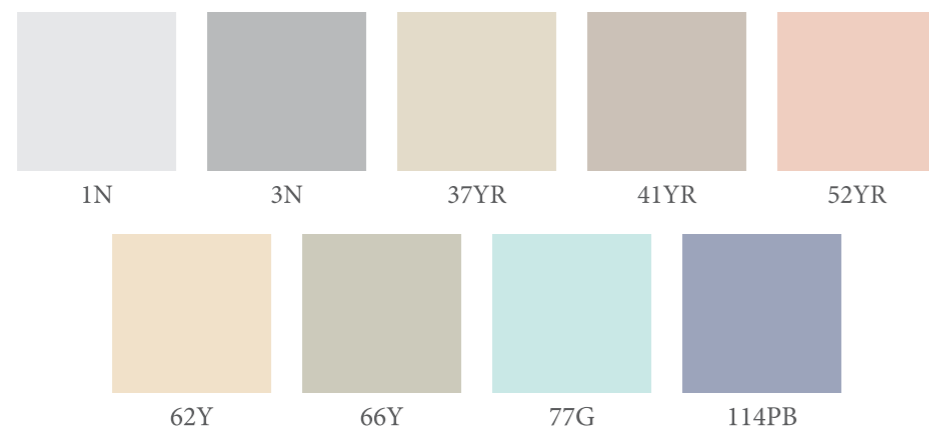

Sample of etching patterns for stainless steel **OPTIONAL**

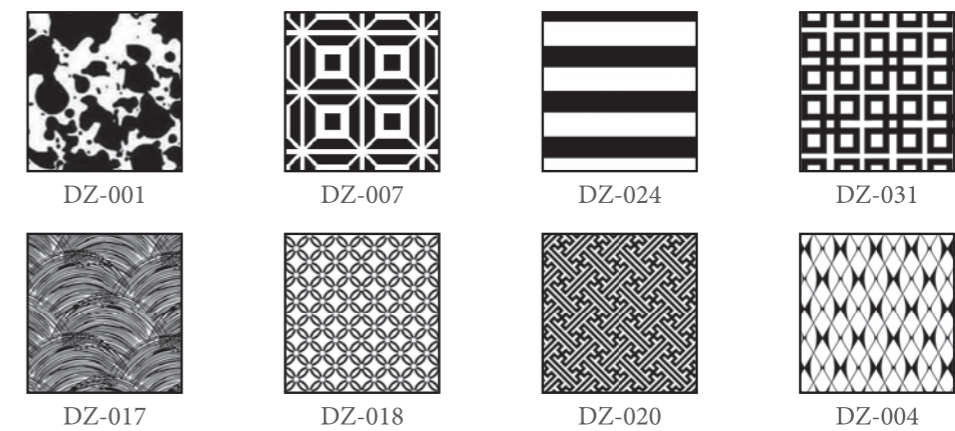

Vinyl tile for car floor **OPTIONAL**

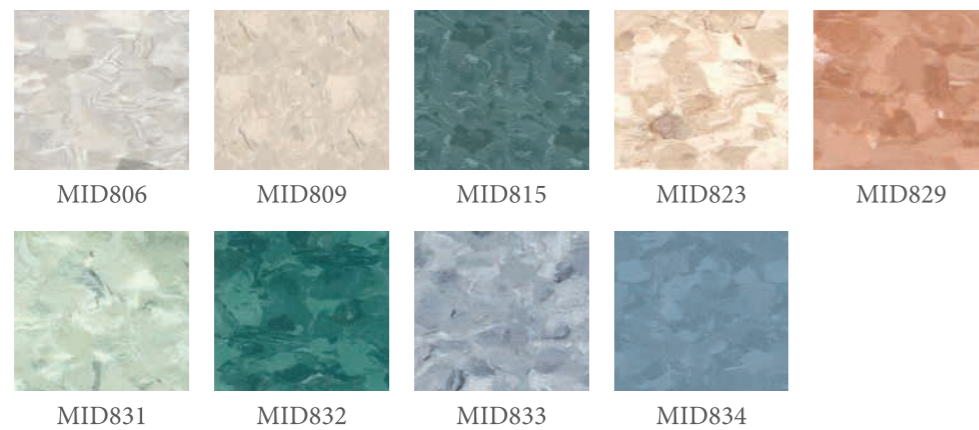

Sample design of tessellated for car floor **OPTIONAL**

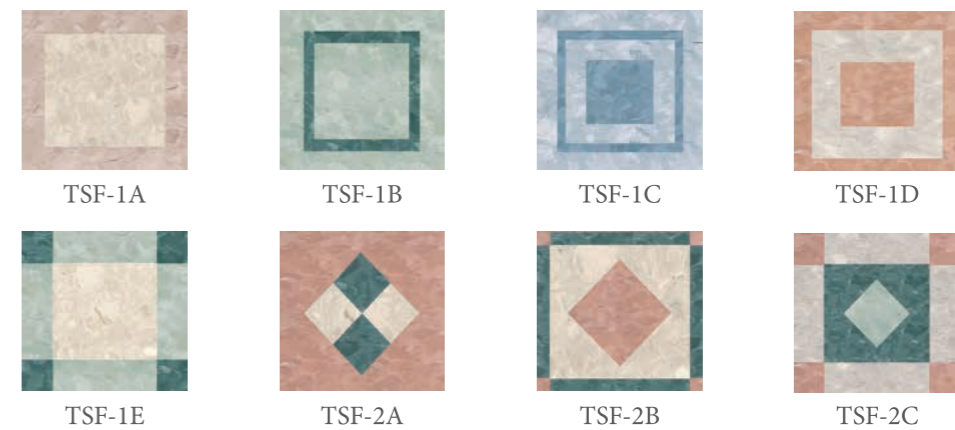

Checker plate for car floor **OPTIONAL**



Marble of car floor **OPTIONAL**

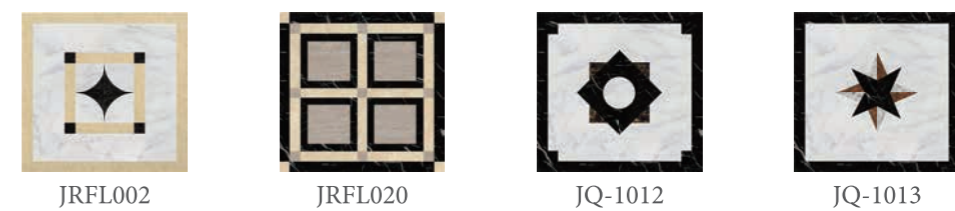

\*The publication of this page is an example of design. Please contact us for other designs.

The actual product colors may vary slightly from those printed colors in this catalog.

The actual product colors may vary slightly from those printed colors in this catalog.

# Other Optional Items

## Hand rail OPTIONAL



Hairline finish stainless steel round type hand rail



Hairline finish stainless steel flat type hand rail



DLX-21 OPTIONAL

## Parking switch

Parking switch is separated from HIB, better design flexibility for faceplate



## Mirror OPTIONAL

Mirror made of glass

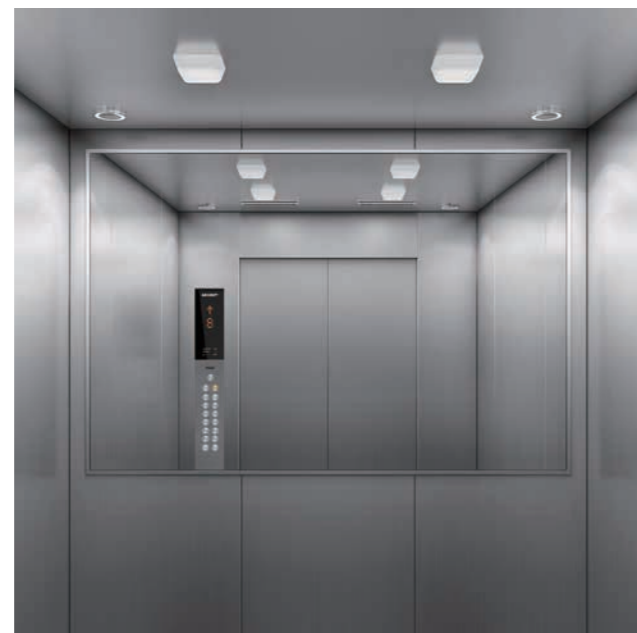

## Fireman switch OPTIONAL

Applied to Fireman switch for "Fireman's operation" in case of provided safety functions



The actual product colors may vary slightly from those printed colors in this catalog.

The actual product colors may vary slightly from those printed colors in this catalog.